



TPS25 Deep Hole Orbital Welding Head For Tubes Sheet High Performance

Our Product Introduction

for more products please visit us on huahengautomation.com

Basic Information

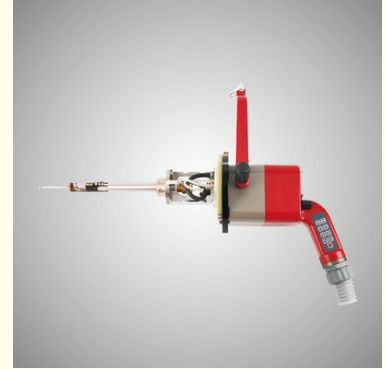

Product Specification

- Weldable Material: Carbon Steel, Stainless Steel
- Tube OD(mm): $\Phi 25$ Or $\Phi 32$ (standard $\Phi 25$)
- Max Depth For Inner Tube(mm): 230(Including Plate Thickness)
- Tube Sheet Connection Form: Tube Flush
- Highlight: **Deep Hole Orbital Welding Head, Tubes Sheet Orbital Welding Head, high performance orbital weld head**

Product Description

Description

This welding head is specially designed for fully automatic TIG welding of deep hole tubes/tube sheets. Suitable for automatic welding of special tube sheet forms. It can weld carbon steel, stainless steel and other tube sheet joints in the form of tube flush joints. The diameter of the weldable

tube is $\Phi 25\text{mm}$ and $\Phi 32\text{mm}$, and two methods of wire filling or self-melting can be used. This machine can be used with iOrbital5000 program-controlled welding power source, which can precisely realize orbital TIG deep hole welding, with high reproducibility of welding results and ideal welding results. It is suitable for automatic welding of special tube sheet forms in boilers, heat exchangers, electric power construction, chemical industry and other industries.



Performance

According to the invisibility of deep hole welding, an automatic arc length control device is specially designed, which automatically corrects the arc voltage by collecting the arc voltage signal feedback principle to maintain a stable distance between the tungsten electrode and the welding surface and automatically adjust the arc length. The arc length can be adjusted manually by turning off the automatic arc length control function;

The automatic lifting function of the workpiece is adopted to ensure the consistency of the height of the tungsten electrode and the workpiece during each welding;

With special torch concealment and torch revealing functions, it is convenient for torch insertion and welding;

Technical parameter

Tungsten electrode diameter(mm)	$\Phi 2.4$
Spinning speed(rpm)	0.37 7.39
Torch inclination	3°
Arc length adjustment spacing(mm)	18
Maximum wire feed speed(mm/min)	1800
Wire diameter(mm)	$\Phi 0.8$
Protective gas	Argon
Cooling method	water cooling
Cooling flow(ml/min)	≥ 300
Rated current	200A duty cycle 60%
Weight(kg)	13(without cable)
Dimensions(mm)	780×290×310

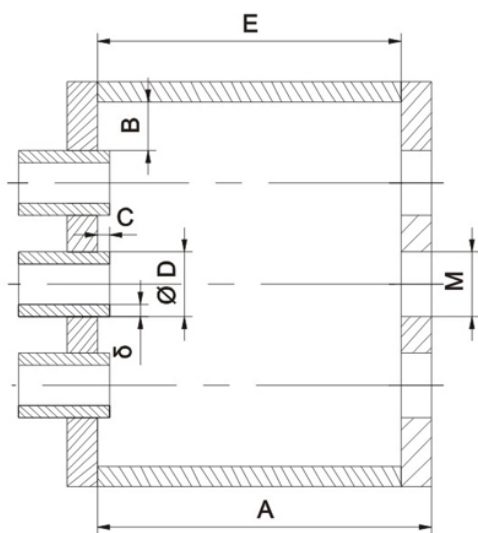

HUAHENG Kunshan Huaheng Welding Co., Ltd.

+86 13962665533

huaheng1995@gmail.com

huahengautom

No.99 WuSongJiang Road, KunShan, JiangSu,
PR.China PC.215334